

InView™

INDUSTRIAL MESSAGE DISPLAYS

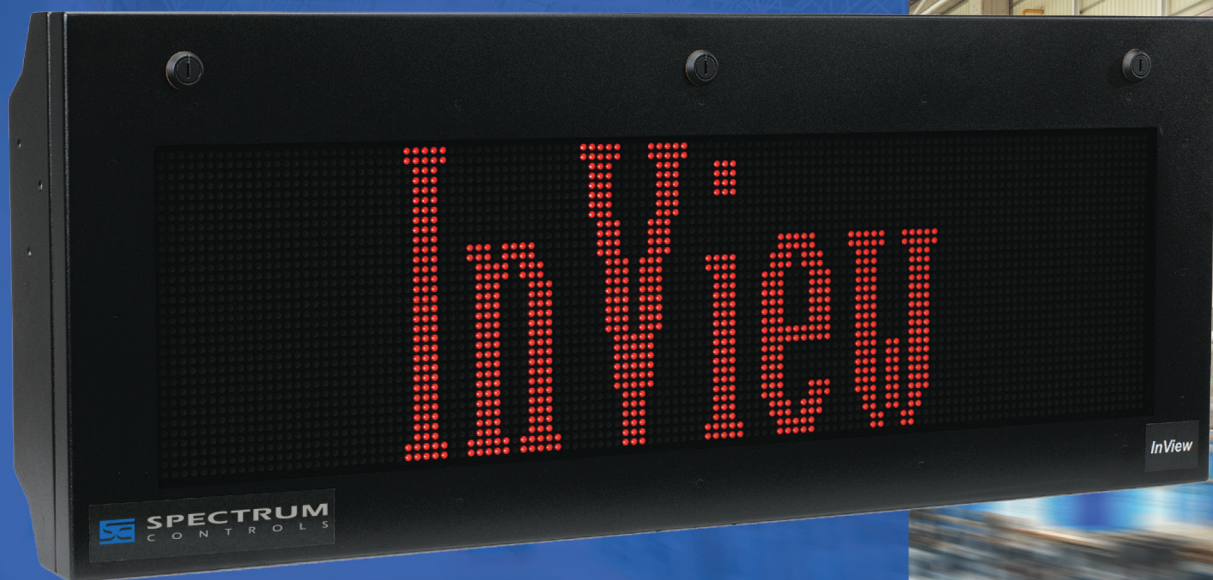

Quick Start Guide

2706-PENETx2-SC

www.spectrumcontrols.com



SILVER
Technology Partner
A ROCKWELL AUTOMATION PARTNER



SPECTRUM
C O N T R O L S

Copyright ©2021 Spectrum Controls, Inc., all rights reserved. Rev 4/2021

Setup for 2706-P22R-SC

Please follow these instructions to setup the P22R display.

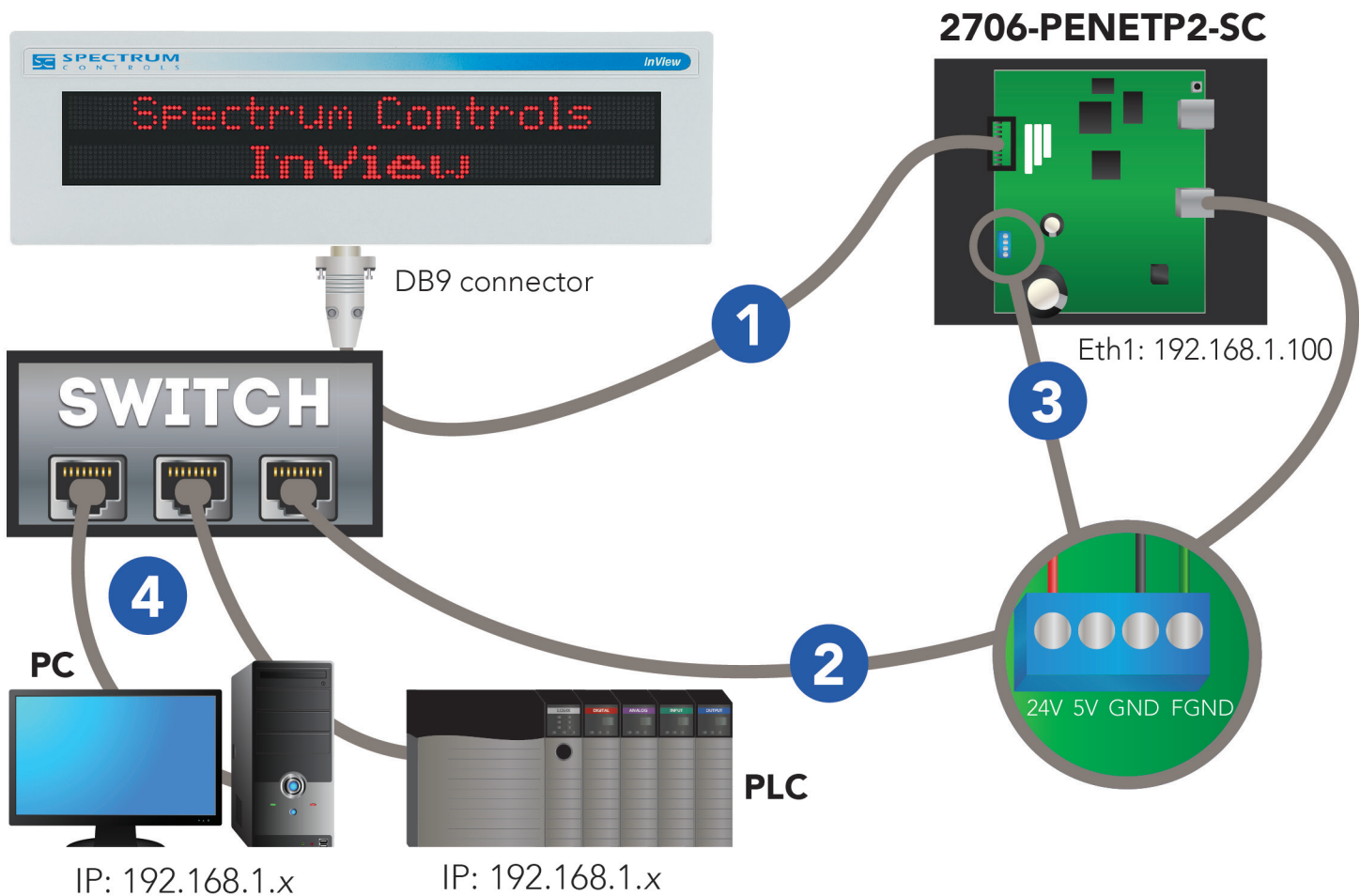

1 Connect the display to the communications module using supplied cable.

2 With a CAT5 cable, connect the comms module to a network switch.

3 Connect 24V DC to comms module.

4 Connect the network switch to both your PC and PLC with a CAT5 cable.

IMPORTANT – PC & PLC must be in the 192.168.1.x subnet!

Setup for 2706-P4x-SC

Please follow these instructions to setup the P4x display.

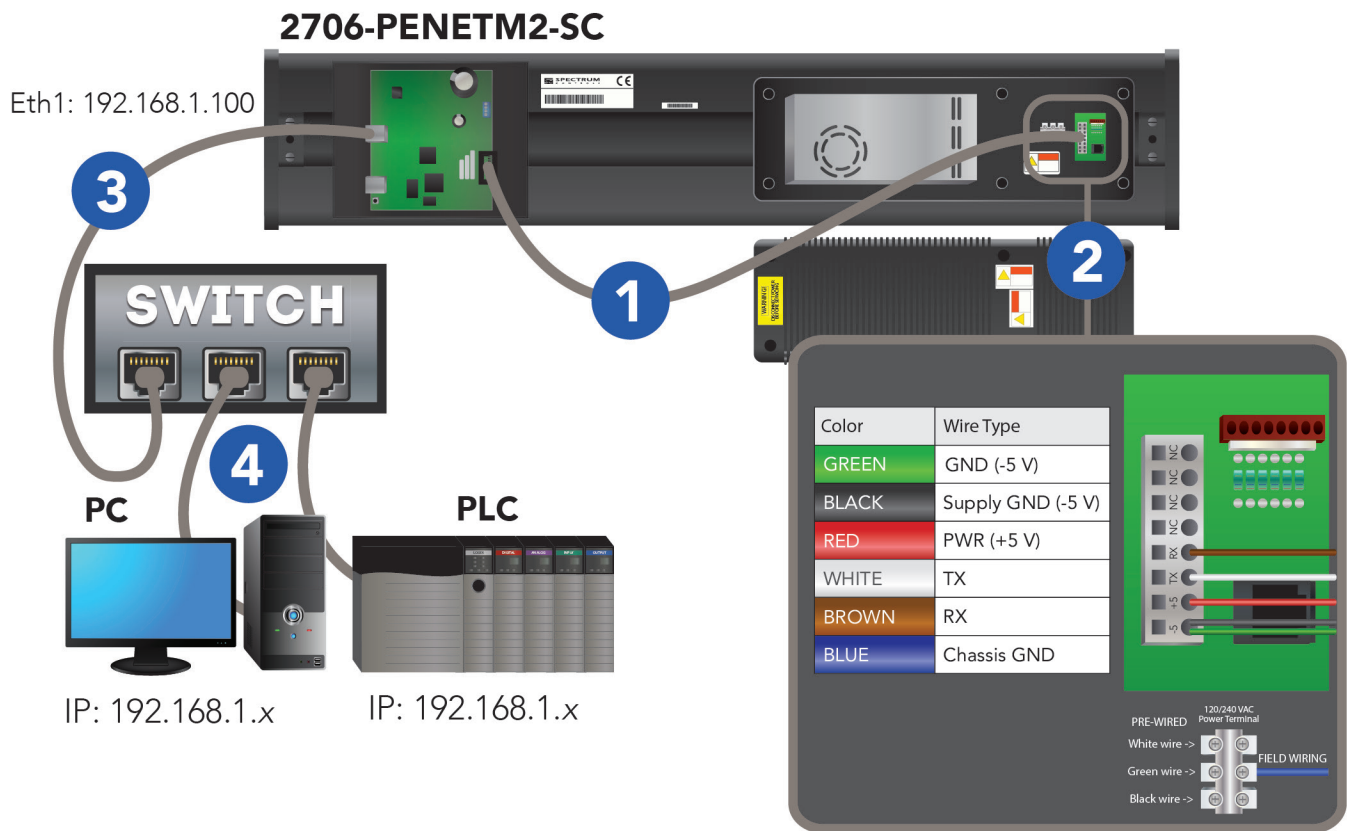

1 Connect the display to the communications module using supplied cable.

2 Wire the comms module as shown in the above wiring diagram.

3 With a CAT5 cable, connect the comms module to a network switch.

4 Connect the network switch to both your PC and PLC with a CAT5 cable.

IMPORTANT – PC & PLC must be in the 192.168.1.x subnet!

Setup for 2706-P4xC2-SC

Please follow these instructions to setup the P4xC2 display.

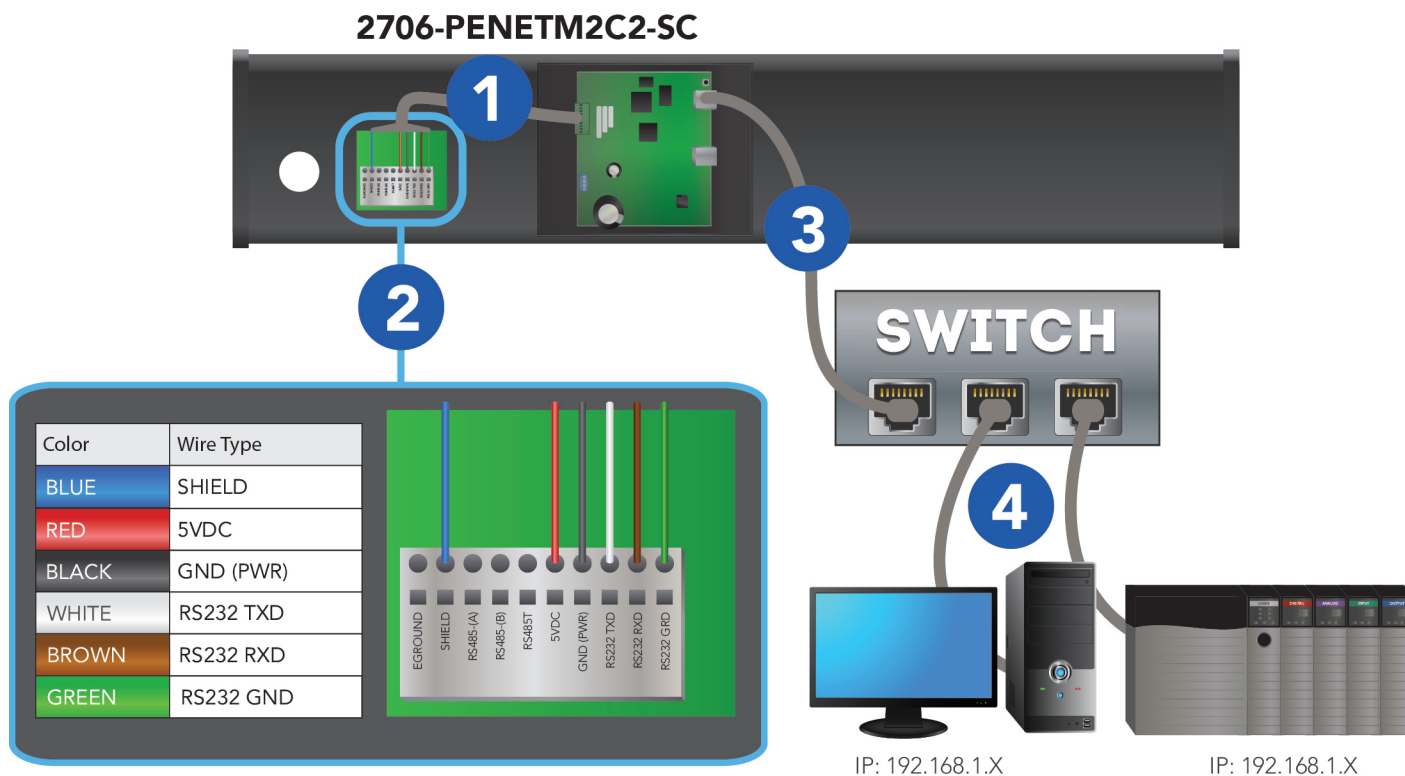

1 Connect the display to the communications module using supplied cable.

2 Wire the comms module as shown in the above wiring diagram.

3 With a CAT5 cable, connect the comms module to a network switch.

4 Connect the network switch to both your PC and PLC with a CAT5 cable.

IMPORTANT – PC & PLC must be in the 192.168.1.x subnet!

Setup for 2706-P7x-SC

Please follow these instructions to setup the P7x display.

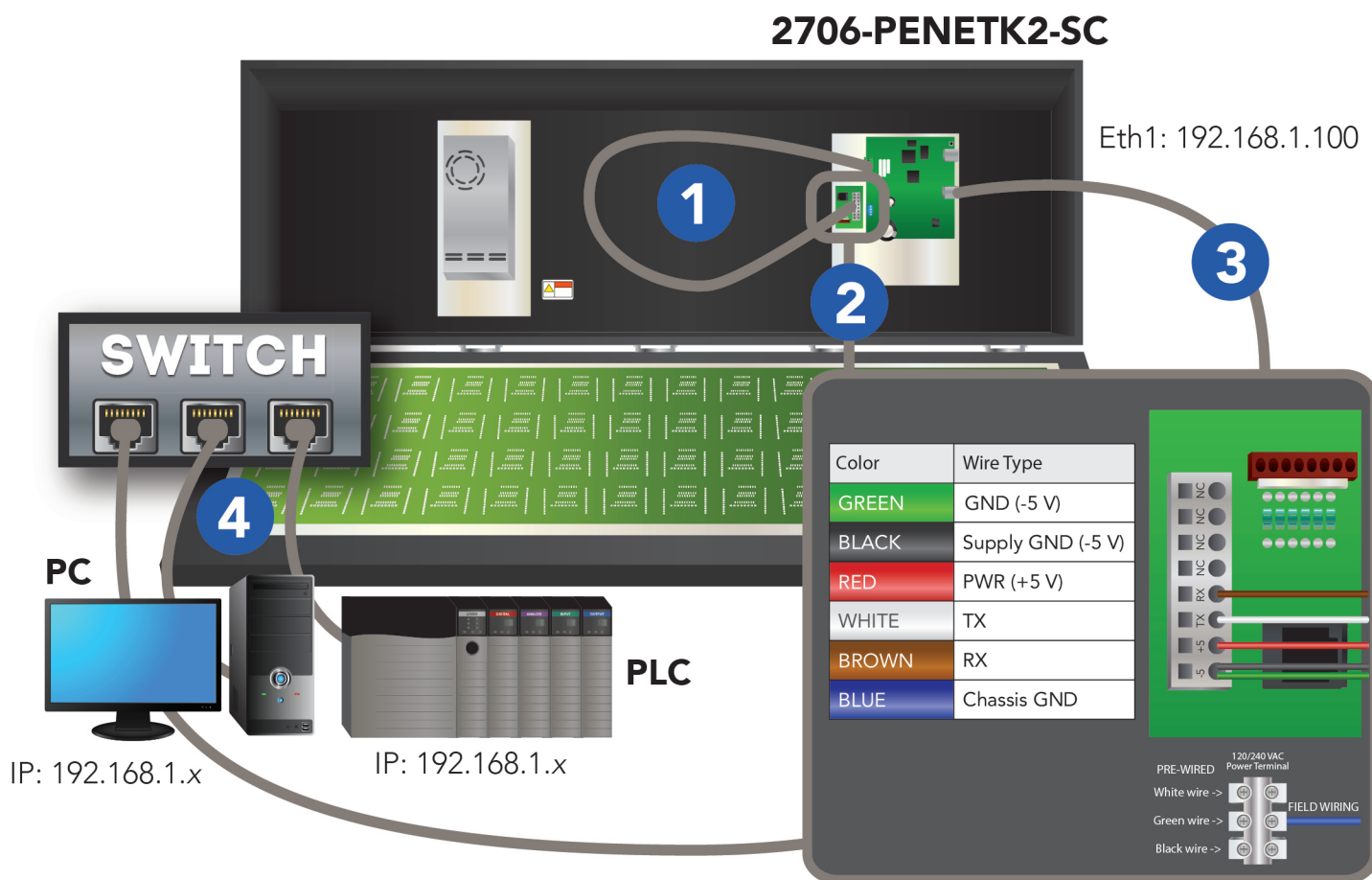

1 Connect the display to the communications module using supplied cable.

2 Wire the comms module as shown in the above wiring diagram.

3 With a CAT5 cable, connect the comms module to a network switch.

4 Connect the network switch to both your PC and PLC with a CAT5 cable.

IMPORTANT – PC & PLC must be in the 192.168.1.x subnet!

Setup for 2706-P9x-SC

Please follow these instructions to setup the P9x display.

2706-PENETK2-SC Eth1: 192.168.1.100

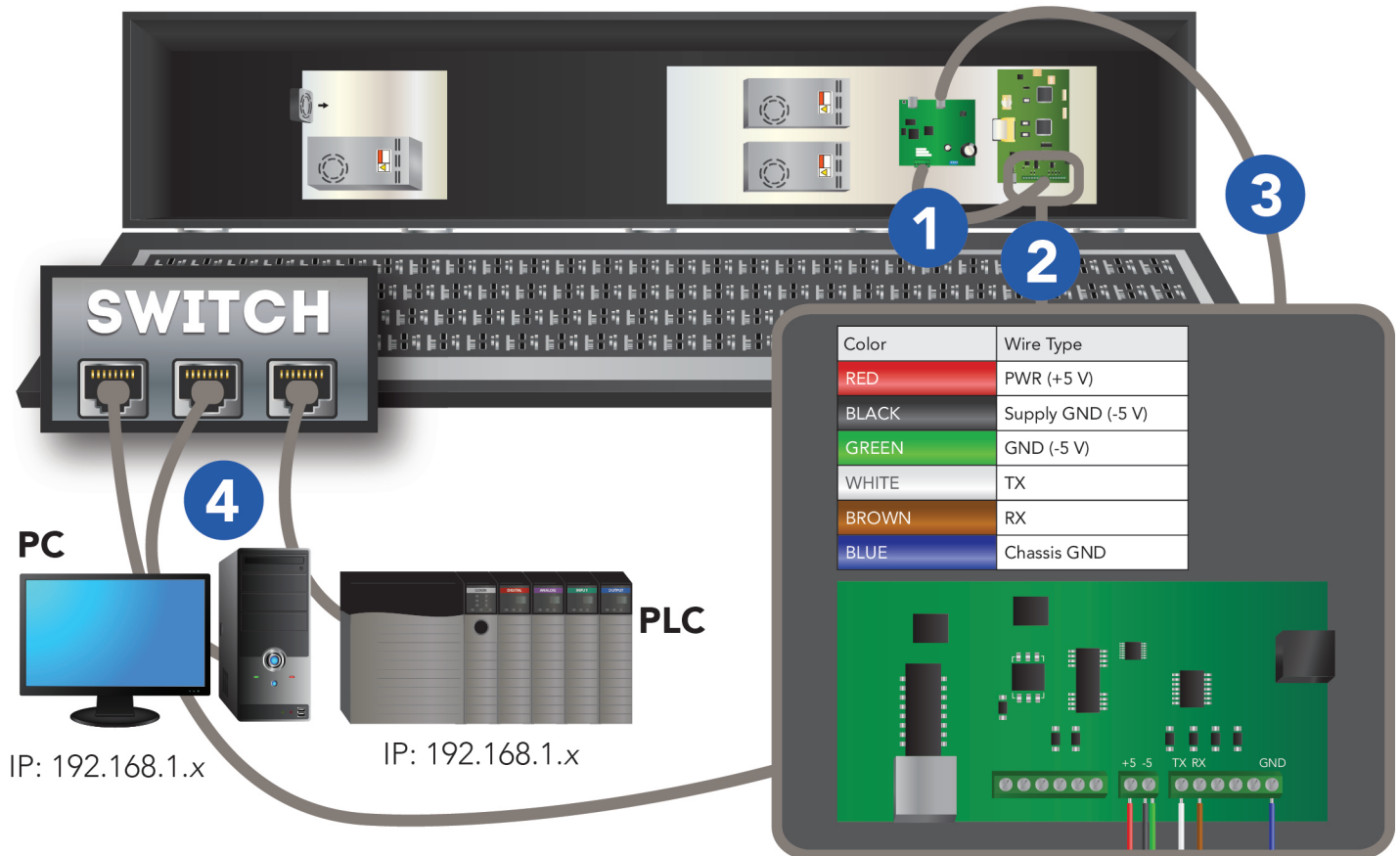

1 Connect the display to the communications module using supplied cable.

2 Wire the comms module as shown in the above wiring diagram.

3 With a CAT5 cable, connect the comms module to a network switch.

4 Connect the network switch to both your PC and PLC with a CAT5 cable.

IMPORTANT – PC & PLC must be in the 192.168.1.x subnet!

Setup for 2706-P9xC2-SC

Please follow these instructions to setup the P22R display.

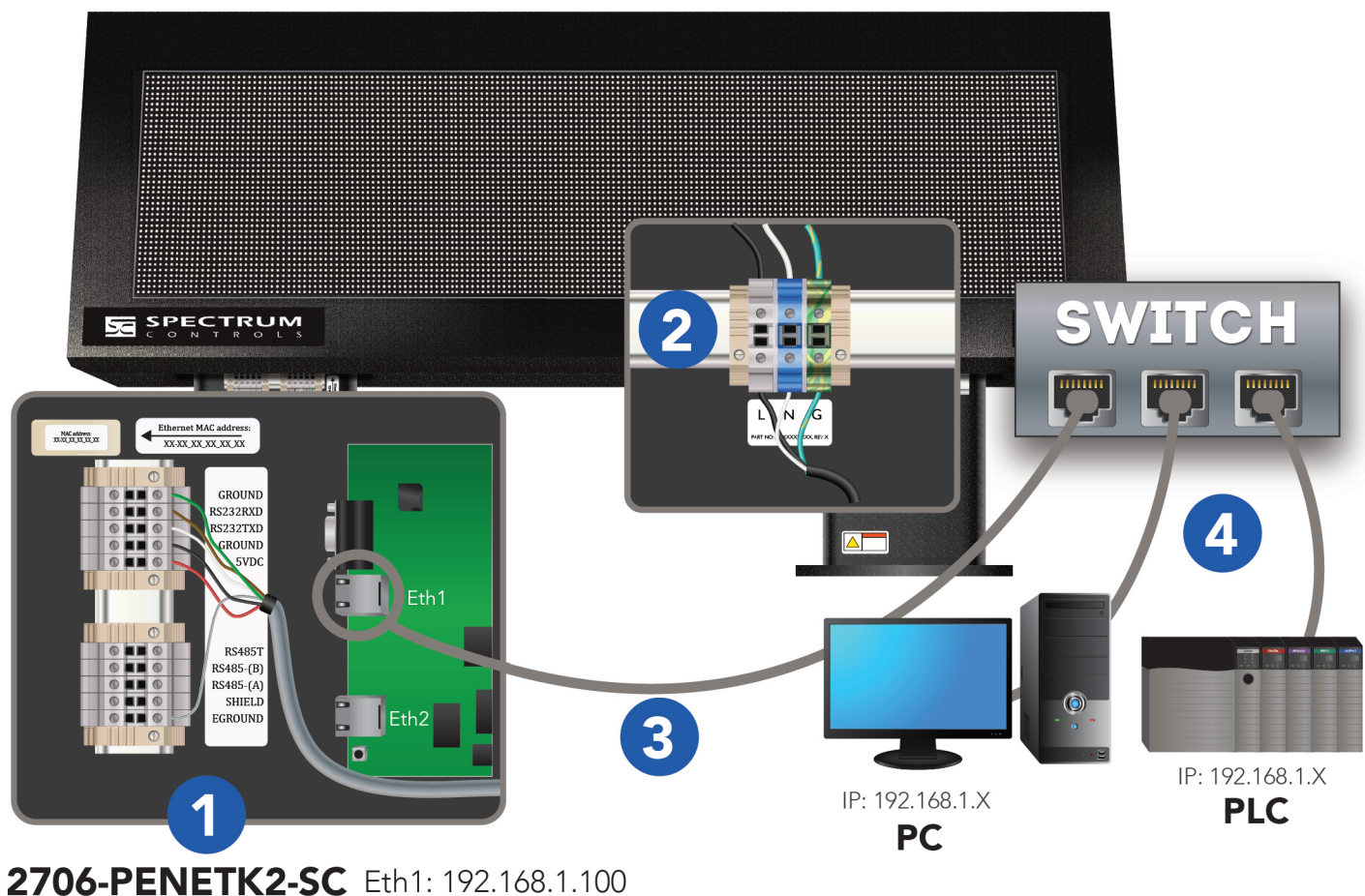

1 Wire the comms module to the display as shown in the above wiring diagram.

2 Connect power as shown in the above wiring diagram.

3 With CAT5 cable, connect the comms module to a network switch.

4 Connect the network switch to both your PC and PLC with CAT5 cable.

IMPORTANT – PC & PLC must be in the 192.168.1.x subnet!

Configuration for Comms Module

Please follow these 3 steps to setup the InView communications module.

Step 1 - Login



Username: admin

Password:

Submit

Open your browser and navigate to "192.168.1.100"

Username: admin

Password: spectrum

Note: You will need to change your PC IP so it's in the same subnet

Step 2 - Network Setup

Network Setup

Eth1

Static IP ☒ DHCP Client ☐

Eth1 IP: 192 . 168 . 1 . 100 *

Subnet Mask: 255 . 255 . 255 . 0 *

Gateway: 192 . 168 . 2 . 1 *

DNS1: 8 . 8 . 8 . 8 *

DNS2:

Cancel

Open Network Setup

Make sure the Eth1 IP setting matches your PLC network

Eth1 and Eth2 cannot be in the same subnet.

Note: The PC and the PLC must be in the same subnet as the InView Eth1 interface.

Note: Only use Eth1, leave Eth2 set to "DHCP"

Step 3 - Master PLC Setup

(For TCP/IP Passthrough, see below.)

Master PLC

Msg Server Type: **ControlLogix**

Device Name: **inview_message_server**

Connection: **Ethernet**

Protocol: **Ethernet/IP**

Address: **10** . **0** . **0** . **223**

TCP Port: **44818**

Slot Number: **0**

Enable Polling: ☒ Delay: **100** ms

Test Device Connection

Message Trigger

Tag Name: **inview_mesg_trigger**

Data Type: **SINT**

Base Addr / Offset: **msg_data** * **0**

Message Data

Tag Name: **inview_mesg_data**

Data Type: **SINT**

Base Addr / Offset: **msg_data** **1**

Array Size: **16** Bytes

Open Master PLC

Select your PLC and enter its IP address.

Enter your PLC server tag values.

Check the enable polling box.

Note: Both message and variable tags must exist on the PLC controller.

TCP/IP Passthrough

Master PLC

Msg Server Type: **Passthrough**

Connection: **Ethernet**

Protocol: **TCP/IP**

TCP Port: **3001**

Open Master PLC

For TCP/IP passthrough, select "Passthrough" for the Msg Server Type.

Set the TCP Port



For more information, please access the InView context-sensitive online help by clicking on the blue button in the upper right corner of the user interface.

Please visit our website for links to the InView user manual, data sheets, install guides, software guides, and add-on instructions.

www.spectrumcontrols.com/InView.html

1705 132nd Ave NE, Bellevue, WA 98005

Telephone : +1 (425) 746-9481 Email: spectrum@spectrumcontrols.com

Specifications subject to change without notice. Printed in USA



SILVER
Technology Partner
A ROCKWELL AUTOMATION PARTNER